



Notice on Updating Software

On January 12, 2016, Microsoft officially ended support for all versions of its Internet Explorer ("IE") browser below version 11. You can read the official announcement [here](#). The Florida PRIME™ website will still function with earlier versions of IE, however Microsoft will no longer be providing security patches or any other technical support for these older versions.

In order to provide enhanced security, the SBA will soon require TLS 1.2 browser encryption for accessing our websites. Current compliant browsers include:

- Chrome - v30 and later supports TLS 1.2.
- Firefox - v27 and later [enables 1.2 by default](#)
- Internet Explorer - v11 supports TLS 1.2 from Feb 2013
- Opera - v17 has added support for TLS 1.2.
- Safari - v5 on iOS and v7 on OS X have added support for up to TLS 1.2

If you cannot upgrade or use one of the above browsers for a time, here is how to configure IE10 and earlier versions to work with TLS 1.2:

1. Select "Tools" > "Internet Options."
 - a. NOTE: Depending on your IE settings, the "Tools" menu may be a gear icon in the upper right hand corner.
2. Go to the "Advanced" tab.
3. Scroll down to the "Security" section.
4. Locate and check "Use TLS 1.2"

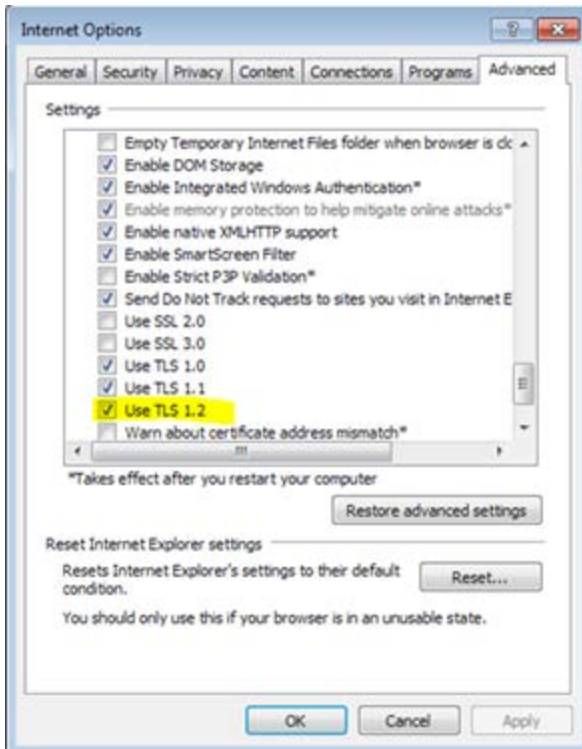

5. Press the "OK" button.

If Internet Explorer is your primary method of accessing the Web, please take the time to upgrade to IE 11 today.

For additional information about Florida PRIME™, please [visit our website](#).



© 2016 State Board of Administration
1801 Hermitage Blvd., Suite 100, Tallahassee, Florida 32308. All Rights Reserved.
The SBA is a licensed user of the iMoneyNet Money Fund Average™ First Tier Institutional Average.